

NOTES:

- THE FOLLOWING DRAWINGS ARE DERIVED FROM:
 - REFERENCE DRAWINGS AS LISTED ON DRG: 6A0000-2120-STW-ESC-0008
 - PDA DETAIL SURVEYS:
 - 44135 27-06-2019
 - 44480 13-09-2019
 - DIAL BEFORE YOU DIG
- UNLESS NOTED OTHERWISE THE LOCATION AND DEPTH OF UNDERGROUND SERVICES SHOWN ARE APPROXIMATE ONLY AND THE EXACT LOCATION, DEPTH AND EXTENT OF SERVICES SHALL BE VERIFIED WITH THE APPROPRIATE AUTHORITY, LOCATED, MARKED AND PROTECTED AS REQUIRED.
- THE APPROPRIATE DUTY OF CARE RESPONSIBILITIES AND OPERATIONAL PROTOCOLS ESTABLISHED BY THE RELEVANT AUTHORITIES SHALL BE ADHERED TO. THIS INCLUDES RESTRICTIONS TO EXCAVATION AND OTHER CONSTRUCTION ACTIVITY IN CLOSE PROXIMITY TO EXISTING SERVICES, INFRASTRUCTURE AND OPERATIONAL CONSTRAINTS.
- THE FOLLOWING DRAWING SET MUST ONLY BE DISTRIBUTED IN FULL COLOUR. TASPOTS ACCEPTS NO LIABILITY ARISING FROM FAILURE TO COMPLY WITH THIS REQUIREMENT.

LINETYPE LEGEND:

- SW — STORMWATER MAIN
- - - - - SUBSOIL DRAIN
- - - - - OPEN DRAIN
- /// REDUNDANT/ INACTIVE SERVICE
- . - . - TASPOTS PROPERTY BOUNDARY

SYMBOLS LEGEND

y x	STORMWATER PIT 'y' DENOTES TYPE SEP - SIDE ENTRY PIT GP - GRATED PIT PP - PUMP PIT MH - MANHOLE 'x' DENOTES ID
DP x	DOWNPIPE 'x' DENOTES ID
◆	ADDITIONAL NOTES STORED WITHIN CAD FILE

ABBREVIATIONS:

DN	DIAMETER
DP	DOWNPIPE
GP	GRATED PIT
HDPE	HIGH-DENSITY POLYETHYLENE
MH	MANHOLE
NB	NOMINAL BORE
PP	PUMP PIT
PVC	POLYVINYL CHLORIDE
RCP	REINFORCED CONCRETE PIPE
SEP	SIDE ENTRY PIT
TBC	TO BE CONFIRMED

Horizontal datum shall be to Geocentric Datum of Australia 1994 (GDA94) Zone 55.
 All levels within TasPorts property shall be nominated relative to Chart Datum (CD), which is Lowest Astronomical Tide (LAT).
 The Chart Datum (CD) is 1.97m below the Australian Height Datum (AHD).
 To convert between AHD and CD a factor of 1.97 must be applied. i.e. AHD 15.268m = CD (LAT) 17.238m

A ISSUED FOR INFORMATION		NJE	PB	SWH	27-05-20
REV	DESCRIPTION	DRAWN	CHECKED	APRVD	DATE

INFORMATION
NOT FOR CONSTRUCTION

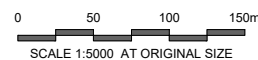

These designs, plans and specifications and the copyright therein are the property of Tasmanian Ports Corporation Pty Ltd and must not be used, reproduced or copied wholly or in part without the written permission of Tasmanian Ports Corporation Pty Ltd.



DRAWN	N. EBERHARDT	22-05-2020
DESIGNED		
DESIGN CHECK		
APPROVED		
SIGNED		DATE

DEVONPORT EAST RECONFIGURATION
SITE-WIDE
EXISTING STORMWATER
LOCALITY PLAN & LEGEND

SCALE	DATUM	PAPER
1:5000	CHART (LAT)	A3
SHEET 1 OF 8		
DRAWING NUMBER	REVISION	
6A0000-2120-STW-ESC-0001	A	

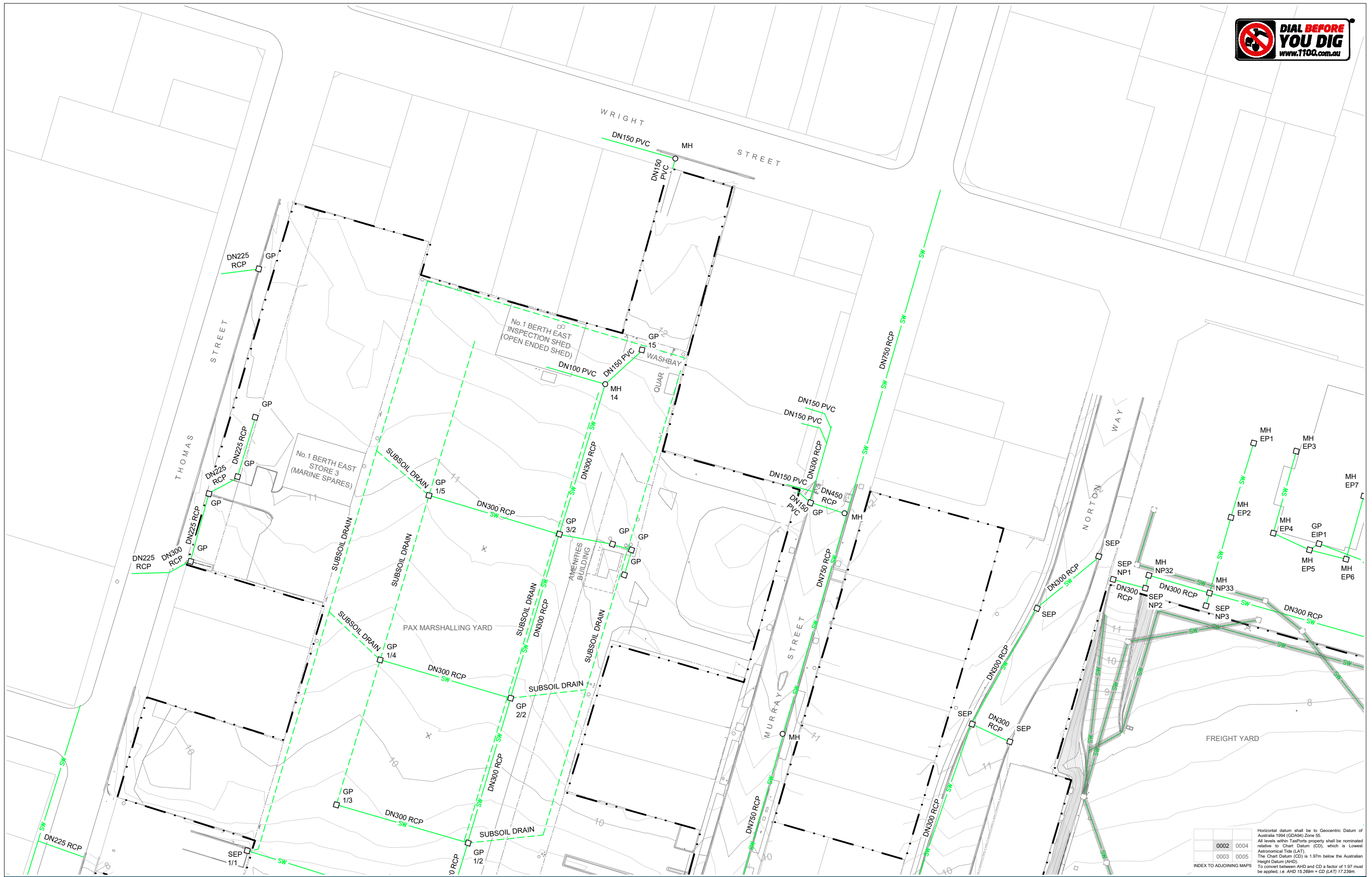

Horizontal datum shall be to Geocentric Datum of Australia 1994 (GDA94) Zone 55.
 All levels within TasPorts property shall be nominated relative to Chart Datum (CD), which is Lowest Astronomical Tide (LAT).
 The Chart Datum (CD) is 1.97m below the Australian Height Datum (AHD).
 To convert between AHD and CD a factor of 1.97 must be applied. i.e. AHD 15.268m = CD (LAT) 17.238m.

REV	DESCRIPTION	DRAWN	CHECKED	APRVD	DATE
A	ISSUED FOR INFORMATION	NJE	PB	SWH	27-05-20

INFORMATION NOT FOR CONSTRUCTION

SCALE 1:1000 AT ORIGINAL SIZE

These designs, plans and specifications and the copyright therein are the property of TasPorts Corporation Pty Ltd and must not be used, reproduced or copied wholly or in part without the written permission of TasPorts Corporation Pty Ltd.

DRAWN	N. EBERHARDT	22-05-2020
DESIGNED		
DESIGN CHECK		
APPROVED		
SIGNED		DATE

**DEVONPORT EAST RECONFIGURATION
 SITE-WIDE
 EXISTING STORMWATER
 ENLARGED PLAN**

SCALE	DATUM	PAPER
1:1000	CHART (LAT)	A3
SHEET 2 OF 8		
DRAWING NUMBER	REVISION	
6A0000-2120-STW-ESC-0002	A	

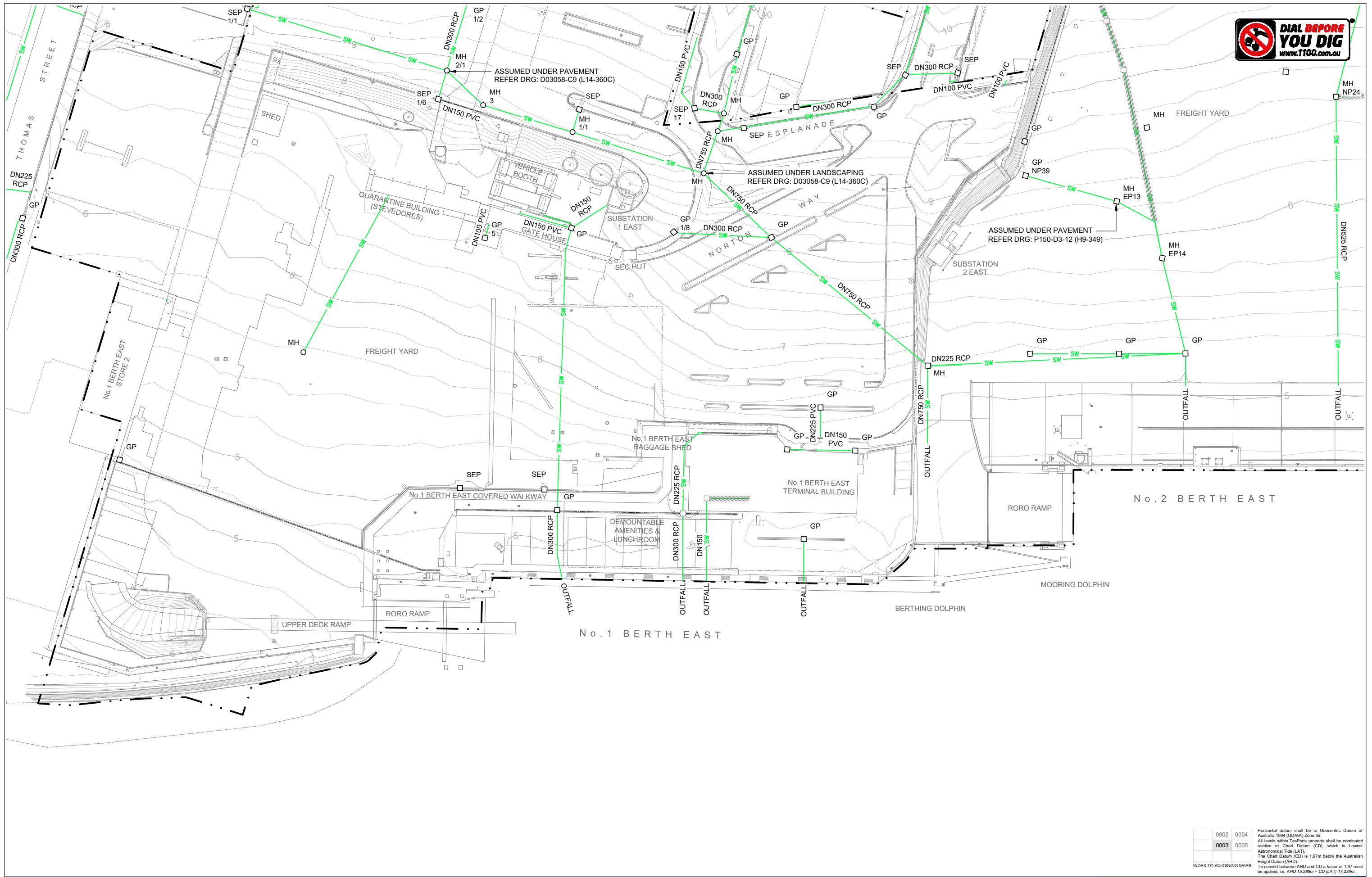

Horizontal datum shall be to Geocentric Datum of Australia 1994 (GDA94) Zone 55.
 All levels within TasPorts property shall be nominated relative to Chart Datum (CD), which is Lowest Astronomical Tide (LAT).
 The Chart Datum (CD) is 1.97m below the Australian Height Datum (AHD).
 To convert between AHD and CD a factor of 1.97 must be applied, i.e. AHD 15.268m = CD (LAT) 17.238m.

REV	DESCRIPTION	DRAWN	CHECKED	APRVD	DATE
A	ISSUED FOR INFORMATION	NJE	PB	SWH	27-05-20

INFORMATION NOT FOR CONSTRUCTION

SCALE 1:1000 AT ORIGINAL SIZE

These designs, plans and specifications and the copyright therein are the property of Tasmanian Ports Corporation Pty Ltd and must not be used, reproduced or copied wholly or in part without the written permission of Tasmanian Ports Corporation Pty Ltd.



DRAWN	N. EBERHARDT	22-05-2020
DESIGNED		
DESIGN CHECK		
APPROVED		
SIGNED		DATE

DEVONPORT EAST RECONFIGURATION SITE-WIDE EXISTING STORMWATER ENLARGED PLAN

SCALE	DATUM	PAPER
1:1000	CHART (LAT)	A3
SHEET 3 OF 8		
DRAWING NUMBER	REVISION	
6A0000-2120-STW-ESC-0003	A	

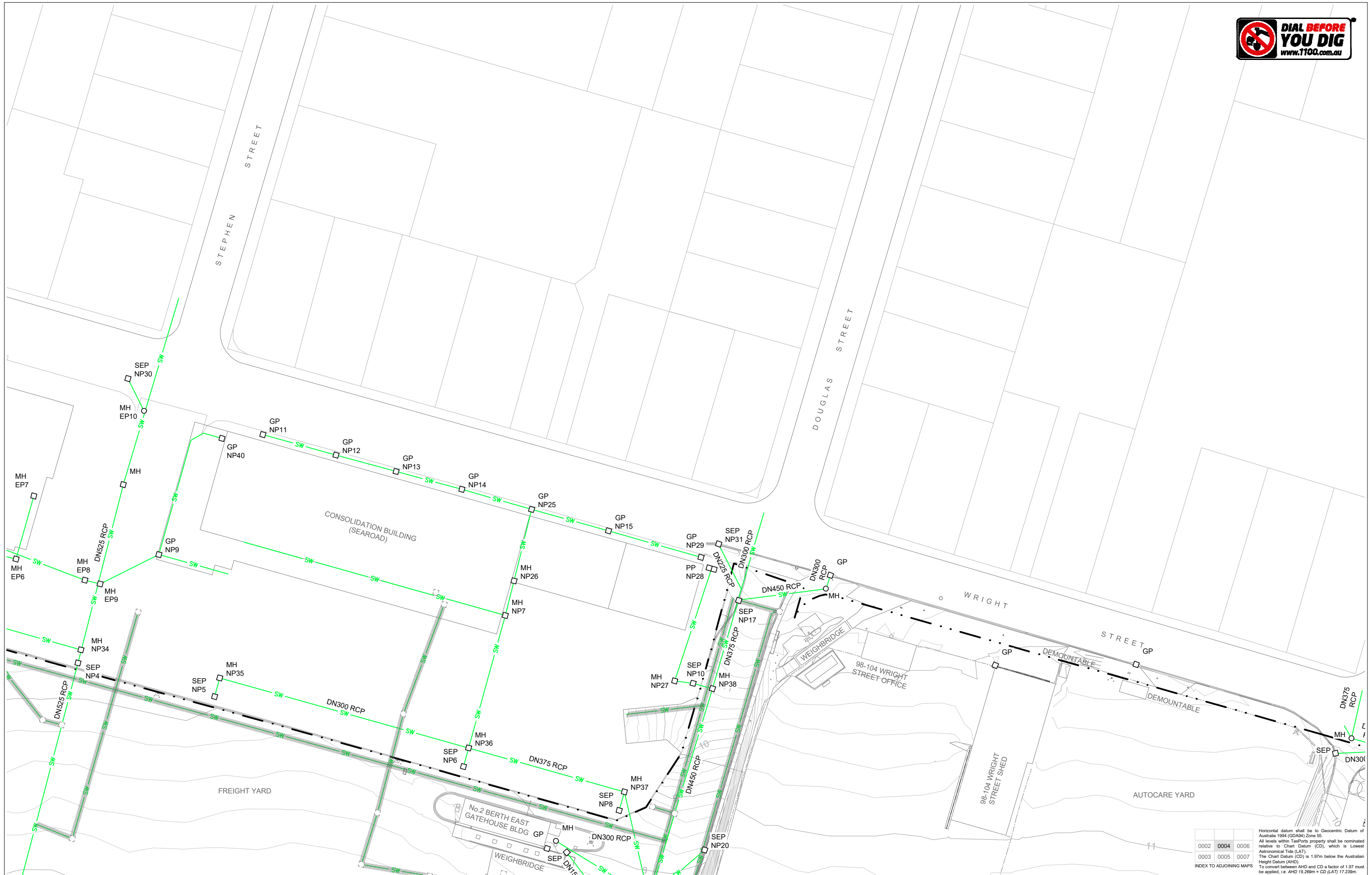

Horizontal datum shall be to Geocentric Datum of Australia 1994 (GDA94) Zone 55.
 All levels within TasPorts property shall be nominated relative to Chart Datum (CD), which is Lowest Astronomical Tide (LAT).
 The Chart Datum (CD) is 1.97m below the Australian Height Datum (AHD).
 To convert between AHD and CD a factor of 1.97 must be applied, i.e. AHD 15.268m = CD (LAT) 17.238m.

0002	0004	0006
0003	0005	0007

INDEX TO ADJOINING MAPS

REV	DESCRIPTION	DRAWN	CHECKED	APRVD	DATE
A	ISSUED FOR INFORMATION	NJE	PB	SWH	27-05-20

INFORMATION NOT FOR CONSTRUCTION

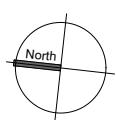
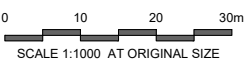

These designs, plans and specifications and the copyright therein are the property of Tasmanian Ports Corporation Pty Ltd and must not be used, reproduced or copied wholly or in part without the written permission of Tasmanian Ports Corporation Pty Ltd.



DRAWN	N. EBERHARDT	22-05-2020
DESIGNED		
DESIGN CHECK		
APPROVED		
SIGNED		DATE

**DEVONPORT EAST RECONFIGURATION
 SITE-WIDE
 EXISTING STORMWATER
 ENLARGED PLAN**

SCALE	DATUM	PAPER
1:1000	CHART (LAT)	A3
SHEET 4 OF 8		
DRAWING NUMBER		REVISION
6A0000-2120-STW-ESC-0004		A

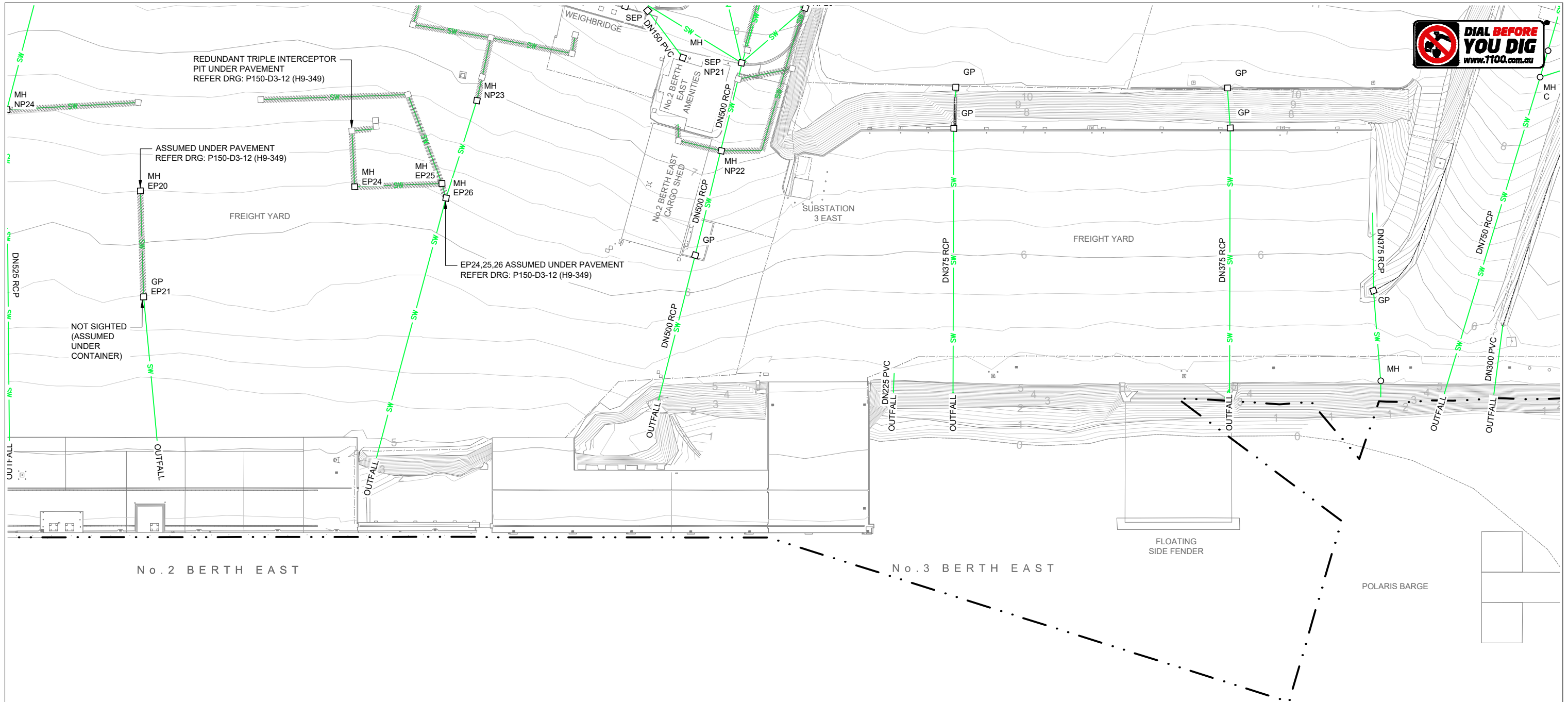

0002	0004	0006	Horizontal datum shall be to Geocentric Datum of Australia 1994 (GDA94) Zone 55. All levels within TasPorts property shall be nominated relative to Chart Datum (CD), which is Lowest Astronomical Tide (LAT). The Chart Datum (CD) is 1.97m below the Australian Height Datum (AHD). To convert between AHD and CD a factor of 1.97 must be applied. i.e. AHD 15.268m = CD (LAT) 17.238m.
0003	0005	0007	
INDEX TO ADJOINING MAPS			

INFORMATION NOT FOR CONSTRUCTION					
SCALE 1:1000 AT ORIGINAL SIZE					
<p>These designs, plans and specifications and the copyright therein are the property of Tasmanian Ports Corporation Pty Ltd and must not be used, reproduced or copied wholly or in part without the written permission of Tasmanian Ports Corporation Pty Ltd.</p>					
DRAWN		N.EBERHARDT		22-05-2020	
DESIGNED					
DESIGN CHECK					
APPROVED					
SIGNED		DATE			
A ISSUED FOR INFORMATION		NJE		PB SWH 27-05-20	
REV	DESCRIPTION	DRAWN	CHECKED	APRVD	DATE

DEVONPORT EAST RECONFIGURATION
SITE-WIDE EXISTING STORMWATER ENLARGED PLAN

SCALE	DATUM	PAPER
1:1000	CHART (LAT)	A3
SHEET 5 OF 8		
DRAWING NUMBER	REVISION	
6A0000-2120-STW-ESC-0005	A	

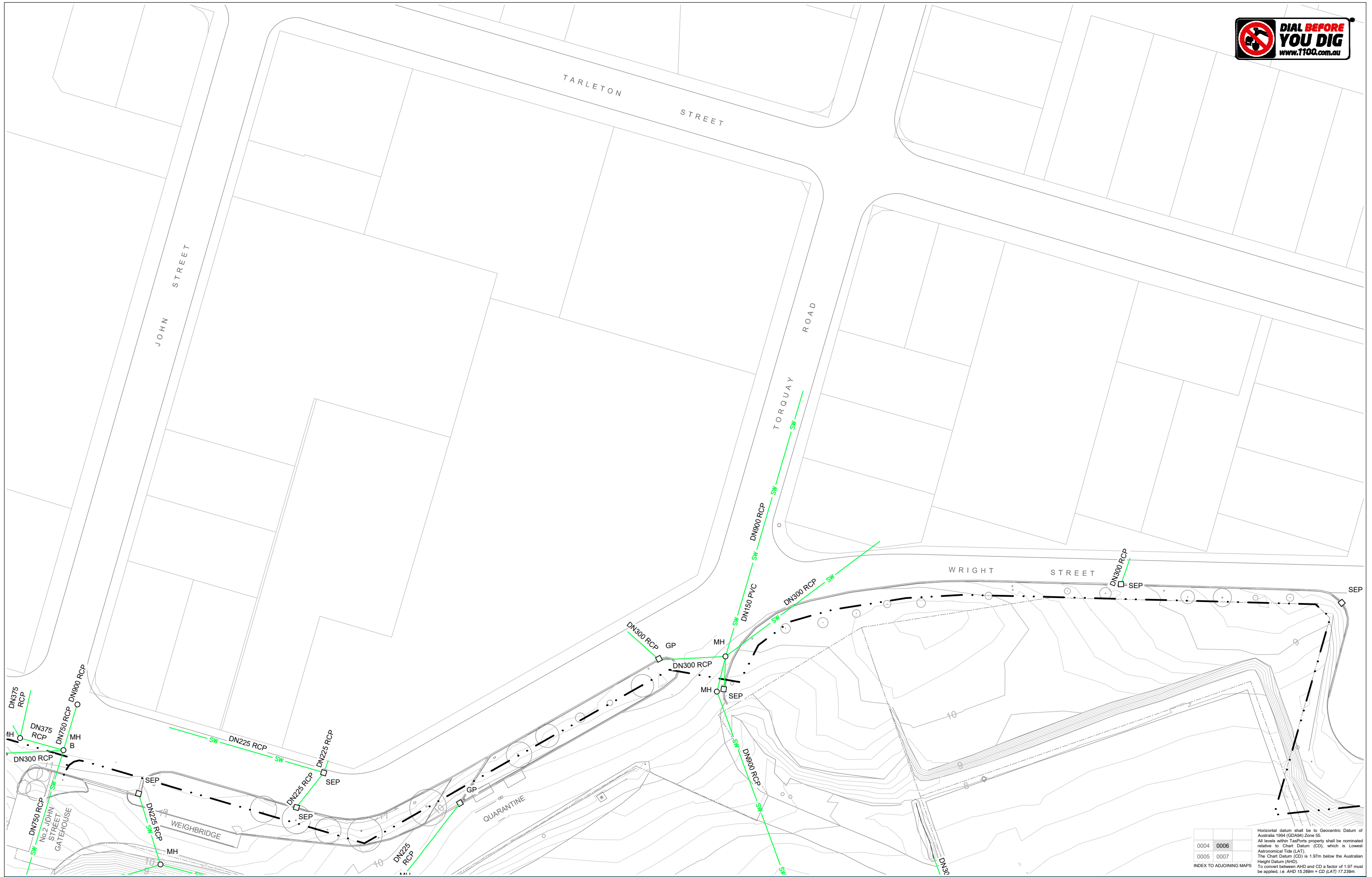

Horizontal datum shall be to Geocentric Datum of Australia 1994 (GDA94) Zone 55. All levels within TasPorts property shall be nominated relative to Chart Datum (CD), which is Lowest Astronomical Tide (LAT). The Chart Datum (CD) is 1.97m below the Australian Height Datum (AHD). To convert between AHD and CD a factor of 1.97 must be applied. i.e. AHD 15.268m = CD (LAT) 17.238m.

0004	0006
0005	0007

INDEX TO ADJOINING MAPS

REV	DESCRIPTION	DRAWN	CHECKED	APRVD	DATE
A	ISSUED FOR INFORMATION	NJE	PB	SWH	27-05-20

INFORMATION NOT FOR CONSTRUCTION



These designs, plans and specifications and the copyright therein are the property of Tasmanian Ports Corporation Pty Ltd and must not be used, reproduced or copied wholly or in part without the written permission of Tasmanian Ports Corporation Pty Ltd.



DRAWN	N. EBERHARDT	22-05-2020
DESIGNED		
DESIGN CHECK		
APPROVED		
SIGNED		DATE

DEVONPORT EAST RECONFIGURATION SITE-WIDE EXISTING STORMWATER ENLARGED PLAN

SCALE	DATUM	PAPER
1:1000	CHART (LAT)	A3
SHEET 6 OF 8		
DRAWING NUMBER		REVISION
6A0000-2120-STW-ESC-0006		A



0004	0006	
0005	0007	

Horizontal datum shall be to Geocentric Datum of Australia 1994 (GDA94) Zone 55.
 All levels within TasPorts property shall be nominated relative to Chart Datum (CD), which is Lowest Astronomical Tide (LAT).
 The Chart Datum (CD) is 1.97m below the Australian Height Datum (AHD).
 To convert between AHD and CD a factor of 1.97 must be applied. i.e. AHD 15.268m = CD (LAT) 17.238m.

INDEX TO ADJOINING MAPS

REV	DESCRIPTION	DRAWN	CHECKED	APRVD	DATE
A	ISSUED FOR INFORMATION	NJE	PB	SWH	27-05-20

**INFORMATION
NOT FOR CONSTRUCTION**

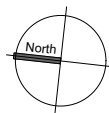
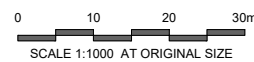

These designs, plans and specifications and the copyright therein are the property of Tasmanian Ports Corporation Pty Ltd and must not be used, reproduced or copied wholly or in part without the written permission of Tasmanian Ports Corporation Pty Ltd.



DRAWN	N.EBERHARDT	22-05-2020
DESIGNED		
DESIGN CHECK		
APPROVED		
SIGNED		DATE

**DEVONPORT EAST RECONFIGURATION
SITE-WIDE
EXISTING STORMWATER
ENLARGED PLAN**

SCALE	DATUM	PAPER
1:1000	CHART (LAT)	A3
SHEET 7 OF 8		
DRAWING NUMBER	REVISION	
6A0000-2120-STW-ESC-0007	A	

Drawing No.	Title	Date
Reference Drawing Set		
Archive Drawings		
H-9-41	Marine Board of Devonport; No.2 Berth East; Drainage & Earthworks	01-10-1969
H-9-345 (sh 0)	Holyman Shipping; TT Line Access Road; Devonport; Project No. P150; Cover Sheet	28-11-2001
H-9-345 (sh 1)	Holyman Shipping; TT Line Access Road; Devonport; Project No. P150; Proposed Site Layout	26-07-2001
H-9-345 (sh 2)	Holyman Shipping; TT Line Access Road; Devonport; Project No. P150; General Arrangement	26-09-2001
H-9-345 (sh 3)	Holyman Shipping; TT Line Access Road; Devonport; Project No. P150; Long Section & Setout Plan	26-07-2001
H-9-345 (sh 4)	Holyman Shipping; TT Line Access Road; Devonport; Project No. P150; Pavement Cross Sections - Sheet 1	26-11-2001
H-9-345 (sh 5)	Holyman Shipping; TT Line Access Road; Devonport; Project No. P150; Pavement Cross Sections - Sheet 2	26-11-2001
H-9-345 (sh 6)	Holyman Shipping; TT Line Access Road; Devonport; Project No. P150; Pavement Cross Sections - Sheet 3	26-11-2001
H-9-345 (sh 7)	Holyman Shipping; TT Line Access Road; Devonport; Project No. P150; Intersection Details 1 of 2	15-11-2001
H-9-345 (sh 7A)	Holyman Shipping; TT Line Access Road; Devonport; Project No. P150; Intersection Details 2 of 2	15-11-2001
H-9-345 (sh 8)	Holyman Shipping; TT Line Access Road; Devonport; Project No. P150; Proposed Drainage Plan	26-11-2001
H-9-345 (sh 9)	Holyman Shipping; TT Line Access Road; Devonport; Project No. P150; Drainage Details	26-07-2001
H-9-345 (sh 10)	Holyman Shipping; TT Line Access Road; Devonport; Project No. P150; Miscellaneous Details	26-07-2001
H-9-345 (sh 11)	Holyman Shipping; TT Line Access Road; Devonport; Project No. P150; Services Plan	26-07-2001
H-9-345 (sh 12)	Holyman Shipping; TT Line Access Road; Devonport; Project No. P150; Existing Pavements	25-07-2001
H-9-345 (sh 13)	Holyman Shipping; TT Line Access Road; Devonport; Project No. P150; Drainage Long Sections	27-11-2001
H-9-347 (sh 0)	Holyman Transport Devonport; Civil Works; Construction Notes	23-04-2002
H-9-347 (sh 1)	Holyman Transport Devonport; Civil Works; Existing Site layout	23-04-2002
H-9-347 (sh 2)	Holyman Transport Devonport; Civil Works; General Arrangement	23-04-2002
H-9-347 (sh 3)	Holyman Transport Devonport; Civil Works; Services Plan	28-04-2002
H-9-347 (sh 4)	Holyman Transport Devonport; Civil Works; Existing Pavements	23-04-2002
H-9-347 (sh 5)	Holyman Transport Devonport; Civil Works; Civil Works; Pavement layout & Design Levels 1 of 2	21-04-2002
H-9-347 (sh 6)	Holyman Transport Devonport; Civil Works; Civil Works; Pavement layout & Design Levels 2 of 2	13-05-2002
H-9-347 (sh 7)	Holyman Transport Devonport; Civil Works; Cross Sections	23-04-2002
H-9-347 (sh 9)	Holyman Transport Devonport; Civil Works; Miscellaneous Details	23-04-2002
H-9-347 (sh 10)	Holyman Transport Devonport; Civil Works; Drainage Plan Layout	08-05-2002
H-9-347 (sh 11)	Holyman Transport Devonport; Civil Works; Drainage Mains Long Sections	08-05-2002
H-9-347 (sh 12)	Holyman Transport Devonport; Civil Works; Drainage Details	23-04-2002
H-9-347 (sh 13)	Holyman Transport Devonport; Civil Works; Pit Details	23-04-2002
H-9-347 (sh 14)	Holyman Transport Devonport; Civil Works; Environmental Protection Details	23-04-2002
H-9-347 (sh 15)	Holyman Transport Devonport; Civil Works; Construction Notes; Splitter Pit Details	23-04-2002
H-9-347 (sh 16)	Holyman Transport Devonport; Civil Works; Construction Notes; Pump Pit Details	23-04-2002
H-9-347 (sh 17)	Holyman Transport Devonport; Civil Works; Construction Notes; Collection Pit Details	23-04-2002
H-9-347 (sh 20)	Holyman Transport Devonport; Civil Works; Pit Schedule	23-04-2002
H-9-347 (sh 27)	Holyman Transport Devonport; Civil Works; DCC Kerb Inlet Pit Details	22-04-2002
H-9-347 (sh 29)	Holyman Transport Devonport; Civil Works; Environmental Bunding Details	02-08-2002
H-9-349 (sh 1)	Patrick Shipping Devonport; Stage 2 Civil Works; Construction Notes	19-08-2002
H-9-349 (sh 2)	Patrick Shipping Devonport; Stage 2 Civil Works; Construction Notes	19-08-2002
H-9-349 (sh 3)	Patrick Shipping Devonport; Stage 2 Civil Works; General Arrangement	19-08-2002
H-9-349 (sh 4)	Patrick Shipping Devonport; Stage 2 Civil Works; Existing Pavements	19-08-2002
H-9-349 (sh 5)	Patrick Shipping Devonport; Stage 2 Civil Works; New Pavement Types	19-08-2002
H-9-349 (sh 6)	Patrick Shipping Devonport; Stage 2 Civil Works; Design Pavement Levels Sheet 1 of 3	19-08-2002
H-9-349 (sh 7)	Patrick Shipping Devonport; Stage 2 Civil Works; Design Pavement Levels Sheet 2 of 3	19-08-2002
H-9-349 (sh 8)	Patrick Shipping Devonport; Stage 2 Civil Works; Design Pavement Levels Sheet 3 of 3	19-08-2002
H-9-349 (sh 9)	Patrick Shipping Devonport; Stage 2 Civil Works; Pavement Sections Sheet 1 of 3	20-08-2002
H-9-349 (sh 10)	Patrick Shipping Devonport; Stage 2 Civil Works; Pavement Sections Sheet 2 of 3	20-08-2002
H-9-349 (sh 11)	Patrick Shipping Devonport; Stage 2 Civil Works; Pavement Sections Sheet 3 of 3	20-08-2002
H-9-349 (sh 12)	Patrick Shipping Devonport; Stage 2 Civil Works; Drainage Layout	20-08-2002
H-9-349 (sh 13)	Patrick Shipping Devonport; Stage 2 Civil Works; Drainage Mains Long Sections	27-09-2002
H-9-349 (sh 14)	Patrick Shipping Devonport; Stage 2 Civil Works; Drainage Details	10-09-2002
H-9-349 (sh 17)	Patrick Shipping Devonport; Stage 2 Civil Works; Retaining Wall Long Section	19-08-2002
H-9-349 (sh 19)	Patrick Shipping Devonport; Stage 2 Civil Works; Inter-terminal Ramp	20-08-2002
H-9-349 (sh 22)	Patrick Shipping Devonport; Stage 2 Civil Works; Existing Services	19-08-2002
H-9-349 (sh 23)	Patrick Shipping Devonport; Stage 2 Civil Works; Pit Schedule	17-09-2002
H-9-349 (sh 25)	Patrick Shipping Devonport; Stage 2 Civil Works; DCC Kerb Inlet Pit & Footpath Details	19-08-2002
H-10-79	Port of Devonport Authority; No.3 East Yard Extension; Services Layout	25-07-1994
H-10-100	Port of Devonport Authority; Coastal Express Line; 2-3 East Berth Development; Kerb & Channel Relocations	18-01-1996
H-10-101	Port of Devonport Authority; Coastal Express Line; 2-3 East Berth Development; Car Park Layout	24-01-1996
H-10-102	Port of Devonport Authority; Coastal Express Line; 2-3 East Berth Development; General Arrangement Sheet 1	20-11-1995
H-10-104	Port of Devonport Authority; Coastal Express Line; 2-3 East Berth Development; Long Sections Sheet 6	12-03-1996
L14-108	Marine Board of Devonport; BSFT Garage; Grease Interceptor Pit & New Concrete Ground Slab	29-04-1997
L14-254	BPSM Pty Ltd; Re-Development; Ferry Terminal Building; Port of Devonport Authority; Drainage Plan	01-04-1985
L14-277	BPSM Pty Ltd; East Devonport Ferry; Terminal Building; Port of Devonport Authority; Sewer & Stormwater; Drainage Plan	01-04-1986
L14-284	Pitt & Sherry; Marine Board of Devonport; Crane Foundation - No.1 Berth East; General Arrangement Plan	26-03-1976
L-14-360a	Pitt & Sherry; TT-Line Vehicle Marshalling and Freight Yard Redevelopment (4 Sheets)	28-08-2003
L-14-360b	Pitt & Sherry; TT-Line Vehicle Marshalling and Freight Yard Redevelopment (4 Sheets)	28-08-2003

Drawing No.	Title	Date
Reference Drawing Set		
Archive Drawings (cont'd)		
L-14-360c	Pitt & Sherry; TT-Line Vehicle Marshalling and Freight Yard Redevelopment (4 Sheets)	28-08-2003
L-14-360d	Pitt & Sherry; TT-Line Vehicle Marshalling and Freight Yard Redevelopment (4 Sheets)	28-08-2003
L-14-360f	Pitt & Sherry; TT-Line Vehicle Marshalling and Freight Yard Redevelopment (4 Sheets)	28-08-2003
L-14-360g	Pitt & Sherry; TT-Line Vehicle Marshalling and Freight Yard Redevelopment (4 Sheets)	28-08-2003
L-16-9b	Marine Board of Devonport; Ferry Terminal; Wharf Apron Drainage	02-05-1961
L-16-10	Marine Board of Devonport; Ferry Terminal; Main Entrance; Revisions & Additions to Existing Stormwater Drainage	13-09-1966
L-16-22	Port of Devonport Corporation; No.1 Berth East; Passenger Walkway; Stormwater Collection A & D	18-09-2002

NOTES:

1. THE REFERENCE DRAWINGS LISTED ARE FOR INFORMATION ONLY. ADDITIONAL WORKS AND OR CHANGES TO THE DESIGNS ARE POSSIBLE, DOCUMENTS HAVE BEEN UNCONTROLLED FROM ISSUE DATE.
2. IF DISCREPANCIES BETWEEN REFERENCE DRAWINGS (LISTED ABOVE) AND THIS DRAWING SET ARE IDENTIFIED PLEASE NOTIFY TASPORTS REPRESENTATIVE FOR CLARIFICATION.

ISSUED FOR INFORMATION					
A	ISSUED FOR INFORMATION	NJE	PB	SWH	27-05-20
REV	DESCRIPTION	DRAWN	CHECKED	APRVD	DATE

**INFORMATION
NOT FOR CONSTRUCTION**

These designs, plans and specifications and the copyright therein are the property of Tasmanian Ports Corporation Pty Ltd and must not be used, reproduced or copied wholly or in part without the written permission of Tasmanian Ports Corporation Pty Ltd.



DRAWN	N. EBERHARDT	22-05-2020
DESIGNED		
DESIGN CHECK		
APPROVED		
	SIGNED	DATE

**DEVONPORT EAST RECONFIGURATION
SITE-WIDE
EXISTING STORMWATER
REFERENCE DRAWING SCHEDULE**

SCALE	DATUM	PAPER
		A3
SHEET 8 OF 8		
DRAWING NUMBER	REVISION	
6A0000-2240-STW-ESC-0008	A	

Horizontal datum shall be to Geocentric Datum of Australia 1994 (GDA94) Zone 55. All levels within TasPorts property shall be nominated relative to Chart Datum (CD), which is Lowest Astronomical Tide (LAT). The Chart Datum (CD) is 1.97m below the Australian Height Datum (AHD). To convert between AHD and CD a factor of 1.97 must be applied. i.e. AHD 15.268m = CD (LAT) 17.238m